

# MAJOR FACILITIES PROJECTS

Under construction and planned

**Project name:**

**Interdisciplinary Science & Engineering Lab**

**Size (sq. ft.):**

**194,000**

**Budget:**

**\$140M**

**Funding source:**

**Funds on hand and gifts**

**Current stage of work:**

**In construction; 73% complete**

**Completion date:**

**May 2013**



**Project name:** East Campus Utility Plant  
**Size (sq. ft.):** 26,000  
**Budget:** \$37.5M  
**Funding source:** Bond and funds on hand  
**Current stage of work:** Substantially complete; partially operational  
**Completion date:** February 2012



**Project name:** Life Sciences Research Facility  
**Size (sq. ft.):** 15,000  
**Budget:** \$12.5M  
**Funding source:** NIH grant, State bond bill funds, funds on hand  
**Current stage of work:** In construction; 55% complete  
**Completion date:** December 2012



**Project name:** Alison Hall Renovation  
**Size (sq. ft.):** 52,258  
**Budget:** \$17.3M  
**Funding source:** State bond bill funds, gifts, funds on hand  
**Current stage of work:** In construction; 55% complete  
**Completion date:** May 2013



**Project name:** Health Sciences Complex – STAR Campus  
**Size (sq. ft.):** 103,000  
**Budget:** \$30.5M  
**Funding source:** Private development firm leasing space to College of Health Sciences and College of Engineering  
**Current stage of work:** Demolition / Abatement  
**Completion date:** December 2013

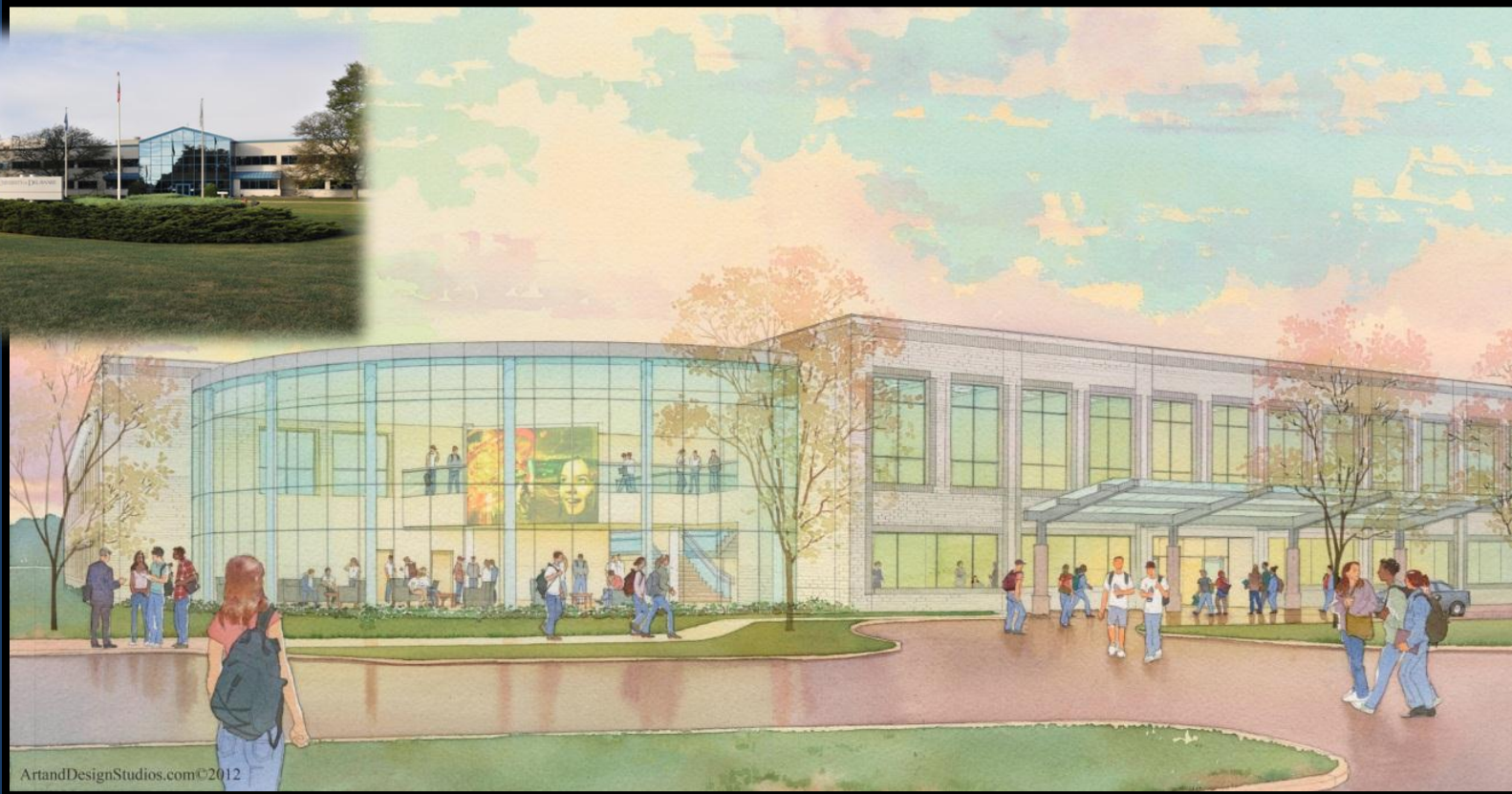

# Drake Organic Chemistry Laboratory Renovation

**Project name:**

**3,500**

**Size (sq. ft.):**

**\$5.5M (approximate)**

**Budget:**

**State bond bill funds, College of Arts & Sciences**

**Funding source:**

**Current stage of work:**

**Design**

**Completion date:**

**2013**



**Project name:** Materials Management Facility  
**Size (sq. ft.):** 5,700  
**Budget:** \$3.7M  
**Funding source:** Funds on hand  
**Current stage of work:** In construction; 2% complete  
**Completion date:** May 2013





**Project name:**  
**Size (sq. ft.):**  
**Budget:**  
**Funding source:**  
**Current stage of work:**  
**Completion date:**

**East Campus Residence Halls “A” and “B”**  
**252,243 (767 beds)**  
**\$84.5M**  
**Bond**  
**In construction; 35% complete**  
**July 2013**



**Project name:** Academy Street Dining and Residence Hall  
**Size (sq. ft.):** 140,000 (303 beds and 1,100 seat dining hall)  
**Budget:** \$62M  
**Funding source:** Bond  
**Current stage of work:** Design; construction starts summer 2013  
**Completion date:** July 2015

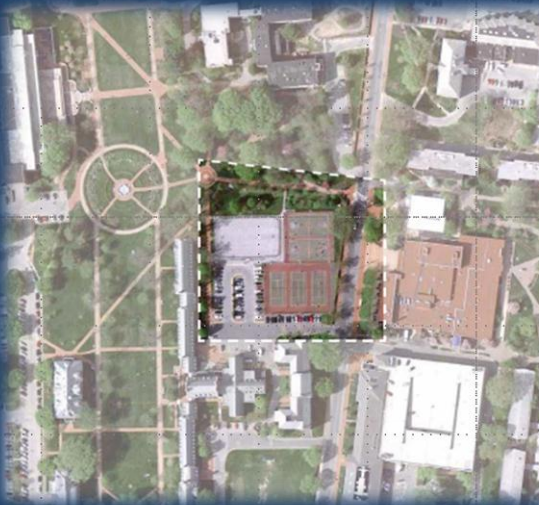

**Project name:** Harrington Residence Hall Renovation  
**Size (sq. ft.):** 133,632 (520 beds + POD + exercise facility)  
**Budget: \$** \$30.75M  
**Funding source:** Bond  
**Current stage of work:** Design; construction starts 2013  
**Completion date:** July 2015



**Project name:**

**Carpenter Sports Building Addition and Renovation**

**Size (sq. ft.):**

**45,000 (addition, interior renovation and deferred maintenance)**

**Budget:**

**\$25M**

**Funding source:**

**Bond**

**Current stage of work:**

**In construction; 10% complete**

**Completion date:**

**August 2013 (addition); November 2013 (renovation)**



**Project name:**  
**Size (sq. ft.):**  
**Budget:**  
**Funding source:**  
**Current stage of work:**  
**Completion date:**

**Bloom Energy Infrastructure – STAR Campus**  
**50 acres**  
**\$3.7M**  
**State of Delaware Infrastructure Fund**  
**In construction; 15% complete**  
**April 2013**



TETRA TECH Bloomenergy

Delaware Factory - Concept  
SITE PERSPECTIVE

TETRA TECH Bloomenergy

Delaware Factory - Concept  
EXTERIOR PERSPECTIVE  
March 12, 2012

# Other Major Projects in Planning

- **Cannon Lab**
- **Lasher Lab**
- **McKinly Lab**
- **Social Sciences Building**
- **501 S. College**
- **Perkins Student Center**
- **Capital Maintenance – numerous locations**